

OPERATION MANUAL

G-FORCE[®]
EV MOW

**GARDEN
PRODUCTS**

**60V
LINE
TRIMMER**

EV LT1



WARNING!

Read this manual carefully before using your line trimmer and keep it in a safe place for future reference.



DESCRIPTION OF PRODUCT PARTS
PACKAGE CONTENT LIST
TECHNICAL SPECIFICATIONS
INTENDED USE
SAFETY INFORMATION
GENERAL SAFETY WARNINGS
ASSEMBLY
OPERATION
CLEANING, MAINTENANCE AND STORAGE
DISPOSAL
TROUBLESHOOTING
WARRANTY

DESCRIPTION OF PRODUCT PARTS

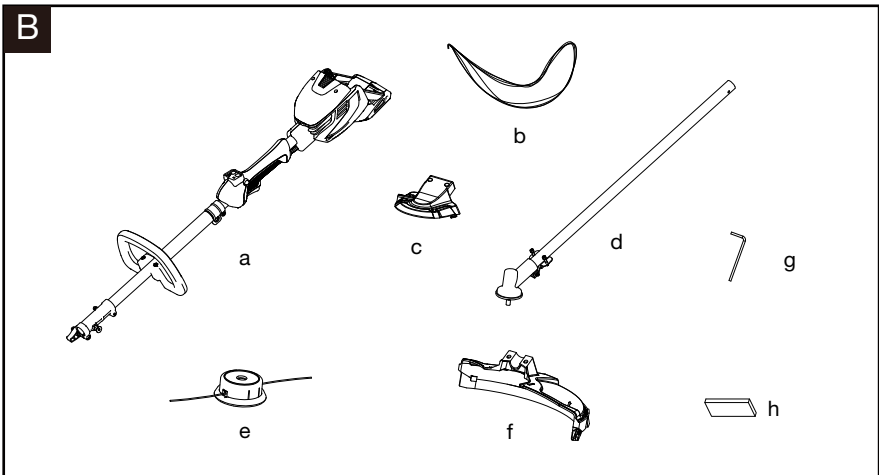
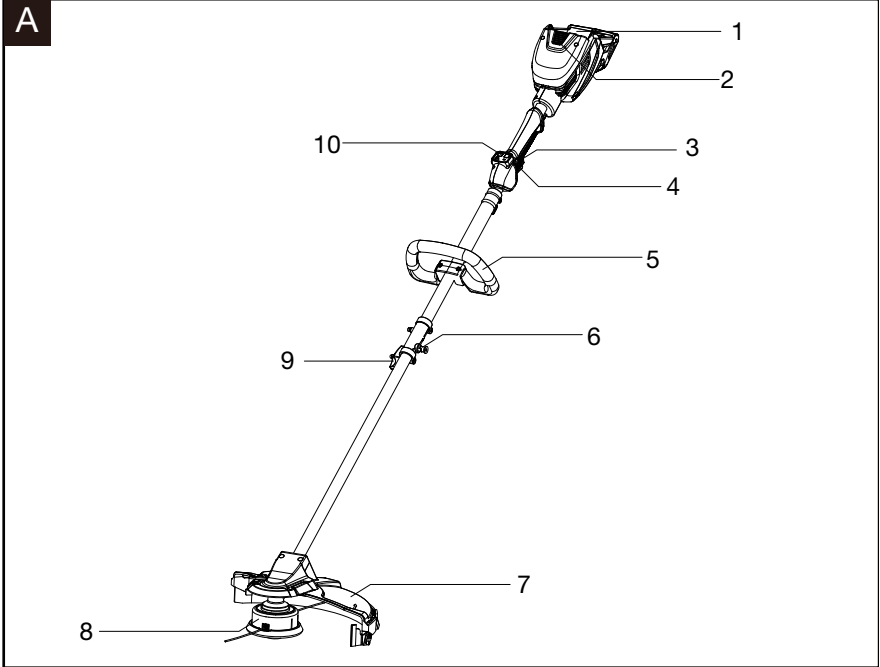

DESCRIPTION OF PARTS (FIG. A)

- | | |
|---------------------------|-------------------|
| 1. Battery compartment | 6. Position pin |
| 2. Battery release button | 7. Safety guard |
| 3. On/off switch | 8. Line spool |
| 4. Safety button | 9. Clamping knob |
| 5. Auxiliary handle | 10. Control panel |

PACKAGE CONTENT LIST (FIG. B)

- Power head
- Shoulder strap
- Safety guard cover
- Lower shaft
- Line spool
- Safety guard
- Allen key
- Instruction manual

- Remove all packing material.
- Check the completeness of the package content.
- Check the line trimmer for transportation damages.



WARNING: Packing materials are not toys! Children must not play with plastic bags! Danger of suffocating!



If any parts are missing or damaged, please contact your dealer.

TECHNICAL SPECIFICATIONS

Model number	EV LT1
Rated voltage	60 Vdc
No load speed	4500/5000/5500 rpm
Cutting diameter	400 mm
Cutting line diameter	2.4 mm
Net weight	4.5 kg

INTENDED USE

The product is intended for cutting weed, grass or similar soft vegetation in areas that are hard to reach, e.g. under bushes, on slopes and edges. It is designed for domestic use and is not designed for commercial or trade use.













WARNING! Please read and understand this instruction manual before use and keep it for your future reference. Your power tool should only be passed on together with this instruction manual.

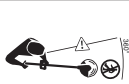

WARNING! To reduce the risk of injury, only use G FORCE battery packs. Other types of battery packs may burst causing personal injury and damage. The battery pack must be recharged only with the G FORCE battery charger.

SAFETY INFORMATION

The following symbols are used in this manual and/or on the line trimmer.

	Warning
	Read the instruction manual before using the appliance
	Wear ear protection
	Wear eye protection
	Do not expose to rain
	Wear protective gloves
	Ensure that other people and pets remain at least 15m away from the line trimmer when it is in use.
	Beware of thrown or flying objects to bystanders. Keep bystanders a safe distance away from the machine
	Sound power level label
	Dispose of the appliance according to the regulations and requirements of your local council
	Australian Regulatory Compliance Mark

GENERAL SAFETY WARNINGS



WARNING Read all safety warnings, instructions, illustrations and specifications provided with this power tool. Failure to follow all instructions listed below may result in electric shock, fire and/or serious injury.

Save all warnings and instructions for future reference.

The term "power tool" in the warnings refers to your mains-operated (corded) power tool or battery-operated (cordless) power tool.

1) Work area safety

- a) **Keep work area clean and well lit.** Cluttered or dark areas invite accidents.
- b) **Do not operate power tools in explosive atmospheres, such as in the presence of flammable liquids, gases or dust.** Power tools create sparks which may ignite the dust or fumes.
- c) **Keep children and bystanders away while operating a power tool.** Distractions can cause you to lose control.

2) Electrical safety

- a) **Power tool plugs must match the outlet. Never modify the plug in any way. Do not use any adapter plugs with earthed (grounded) power tools.** Unmodified plugs and matching outlets will reduce risk of electric shock.
- b) **Avoid body contact with earthed or grounded surfaces, such as pipes, radiators, ranges and refrigerators.** There is an increased risk of electric shock if your body is earthed or grounded.
- c) **Do not expose power tools to rain or wet conditions.** Water entering a power tool will increase the risk of electric shock.
- d) **Do not abuse the cord. Never use the cord for carrying, pulling or unplugging the power tool. Keep cord away from heat, oil, sharp edges or moving parts.** Damaged or entangled cords increase the risk of electric shock.
- e) **When operating a power tool outdoors, use an extension cord suitable for outdoor use.** Use of a cord suitable for outdoor use reduces the risk of electric shock.
- f) **If operating a power tool in a damp location is unavoidable, use a residual current device (RCD) protected supply.** Use of an RCD reduces the risk of electric shock.

3) Personal safety

- a) **Stay alert, watch what you are doing and use common sense when operating a power tool. Do not use a power tool while you are tired or under the influence of drugs, alcohol or medication.** A moment of inattention while operating power tools may result in serious personal injury.
- b) **Use personal protective equipment. Always wear eye protection.**

Protective equipment such as a dust mask, non-skid safety shoes, hard hat or hearing protection used for appropriate conditions will reduce personal injuries.

- c) **Prevent unintentional starting. Ensure the switch is in the off-position before connecting to power source and/or battery pack, picking up or carrying the tool.** Carrying power tools with your finger on the switch or energising power tools that have the switch on invites accidents.
 - d) **Remove any adjusting key or wrench before turning the power tool on.** A wrench or a key left attached to a rotating part of the power tool may result in personal injury.
 - e) **Do not overreach. Keep proper footing and balance at all times.** This enables better control of the power tool in unexpected situations.
 - f) **Dress properly. Do not wear loose clothing or jewellery. Keep your hair and clothing away from moving parts.** Loose clothes, jewellery or long hair can be caught in moving parts.
 - g) **If devices are provided for the connection of dust extraction and collection facilities, ensure these are connected and properly used.** Use of dust collection can reduce dust-related hazards.
 - h) **Do not let familiarity gained from frequent use of tools allow you to become complacent and ignore tool safety principles.** A careless action can cause severe injury within a fraction of a second.
- 4) **Power tool use and care**
- a) **Do not force the power tool.** Use the correct power tool for your application. The correct power tool will do the job better and safer at the rate for which it was designed.
 - b) **Do not use the power tool if the switch does not turn it on and off.** Any power tool that cannot be controlled with the switch is dangerous and must be repaired.
 - c) **Disconnect the plug from the power source and/or remove the battery pack, if detachable, from the power tool before making any adjustments, changing accessories, or storing power tools.** Such preventive safety measures reduce the risk of starting the power tool accidentally.
 - d) **Store idle power tools out of the reach of children and do not allow persons unfamiliar with the power tool or these instructions to operate the power tool.** Power tools are dangerous in the hands of untrained users.
 - e) **Maintain power tools and accessories.** Check for misalignment or binding of moving parts, breakage of parts and any other condition that may affect the power tool's operation. If damaged, have the power tool repaired before use. Many accidents are caused by poorly maintained power tools.
 - f) **Keep cutting tools sharp and clean.** Properly maintained cutting tools with sharp cutting edges are less likely to bind and are easier to control.
 - g) **Use the power tool, accessories and tool bits etc. in accordance with these instructions, taking into account the working conditions and the work to be performed.** Use of the power tool for operations different from those intended could result in a hazardous situation.

GENERAL SAFETY WARNINGS

- h) **Keep handles and grasping surfaces dry, clean and free from oil and grease.** Slippery handles and grasping surfaces do not allow for safe handling and control of the tool in unexpected situations.

5) Battery tool use and care

- a) **Recharge only with the charger specified by the manufacturer.** A charger that is suitable for one type of battery pack may create a risk of fire when used with another battery pack.
- b) **Use power tools only with specifically designated battery packs.** Use of any other battery packs may create a risk of injury and fire.
- c) **When battery pack is not in use, keep it away from other metal objects, like paper clips, coins, keys, nails, screws or other small metal objects, that can make a connection from one terminal to another.** Shorting the battery terminals together may cause burns or a fire.
- d) **Under abusive conditions, liquid may be ejected from the battery; avoid contact. If contact accidentally occurs, flush with water. If liquid contacts eyes, additionally seek medical help.** Liquid ejected from the battery may cause irritation or burns.
- e) **Do not use a battery pack or tool that is damaged or modified.** Damaged or modified batteries may exhibit unpredictable behaviour resulting in fire, explosion or risk of injury.
- f) **Do not expose a battery pack or tool to fire or excessive temperature.** Exposure to fire or temperature above 130 °C may cause explosion.
- g) **Follow all charging instructions and do not charge the battery pack or tool outside the temperature range specified in the instructions.** Charging improperly or at temperatures outside the specified range may damage the battery and increase the risk of fire.

6) Service

- a) **Have your power tool serviced by a qualified repair person using only identical replacement parts.** This will ensure that the safety of the power tool is maintained.
- b) **Never service damaged battery packs.** Service of battery packs should only be performed by the manufacturer or authorized service providers.

7) Safety warnings of line trimmer

- a) **Do not use the machine in bad weather conditions, especially when there is a risk of lightning.** This decreases the risk of being struck by lightning.
- b) **Thoroughly inspect the area for wildlife where the machine is to be used.** Wildlife may be injured by the machine during operation.
- c) **Thoroughly inspect the area where the machine is to be used and remove all stones, sticks, wires, bones and other foreign objects.** Thrown objects can cause personal injury.
- d) **Before using the machine, always visually inspect to see that the cutter and the cutting assembly are not damaged.** Damaged parts increase the

risk of injury.

- e) **Keep guards in place. Guards must be in working order and be properly mounted.** A guard that is loose, damaged, or is not functioning correctly may result in personal injury.
- f) **Keep all cooling air inlets clear of debris.** Blocked air inlets and debris may result in overheating or risk of fire.
- g) **Wear eye protection and ear protection.** Adequate protective equipment will reduce personal injury.
- h) **While operating the machine, always wear non-slip and protective footwear.** Do not operate the machine when barefoot or wearing open sandals. This reduces the chance of injury to the feet from contact with the moving cutter.
- i) **Always wear clothing such as trousers that covers the operator's legs while operating the machine.** Contact with the moving cutter or line may cause injury.
- j) **Keep bystanders away while operating the machine.** Thrown debris can result in serious personal injury.
- k) **Do not operate the machine above waist height.** This helps prevent unintended cutter contact and enables better control of the machine in unexpected situations.
- l) **Exercise caution when operating the machine in wet grass. Walk never run.** This reduces the risk of slipping and falling which may result in personal injury.
- m) **Do not operate the machine on excessively steep slopes.** This reduces the risk of loss of control, slipping and falling which may result in personal injury.
- n) **When working on slopes, always be sure of your footing, always work across the face of slopes, never up or down and exercise extreme caution when changing direction.** This reduces the risk of loss of control, slipping and falling which may result in personal injury.
- o) **Keep all parts of the body away from the mowing trimmer cutter or line.** Do not clear material from the machine until it has been disconnected from the power source. The moving trimmer cutter or line may result in serious personal injury.
- p) **Carry the machine with the machine switched off and away from your body.** Proper handling of the machine will reduce the likelihood of accidental contact with a moving trimmer cutter or line.
- q) **Only use replacement cutting heads and trimmer cutters or lines specified by the manufacturer.** Do not replace the trimmer cutters or lines with metal wires or blades. Incorrect replacement parts may cause loss of control, breakage and injury.

ASSEMBLY



WARNING! Remove the battery packs from the line trimmer before assembling the line trimmer.

Attaching the safety guard(Fig. 1)

1. Loosen and remove the two screws from the shaft.
2. Align the holes on the safety guard cover, shaft and safety guard, insert the two screws through the holes and tighten.

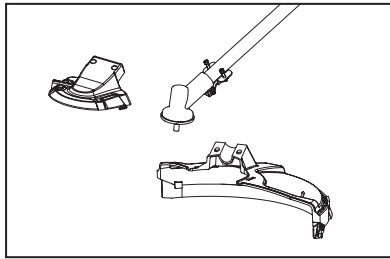

(Fig. 1)

Installing the line spool(Fig. 2)

1. Insert an allen key through the hole in the cutting head to lock the spindle. Rotate the spindle until the hex wrench is fully inserted.
2. Place the line spool onto the spindle and tighten it by hand.
3. Remove the allen key from the cutting head.

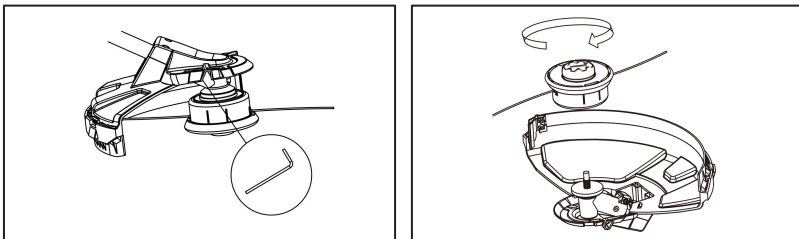

(Fig. 2)

Joining the upper and lower shafts (Fig. 3)

1. Loosen the clamping knob and pull the position pin outward and turn it 90°
2. Join the driving shafts inside the lower and upper shafts together.
3. Align the hole in the lower shaft with the location pin in the upper shaft. Insert the lower shaft into the upper shaft.

4. Rotate the location pin 90° and release it, so that it can be inserted through the hole of the lower shaft.
5. Tighten the connector knob and make sure that the lower shaft is secured.

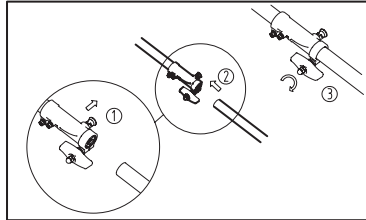

(Fig. 3)

1. Place the auxiliary handle on the upper shaft.
2. Insert two screws through the clamp and tighten them with the nuts on the auxiliary handle.

Installing the auxiliary handle (Fig. 4)

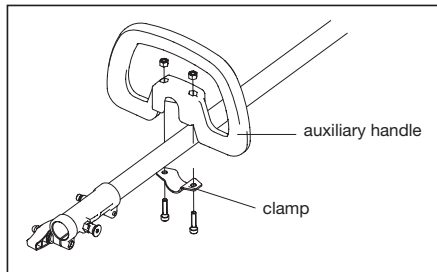

(Fig. 4)

Fitting the shoulder strap (Fig. 5)

Hook the shoulder strap to the harness ring on the line trimmer and make sure that it is secured.

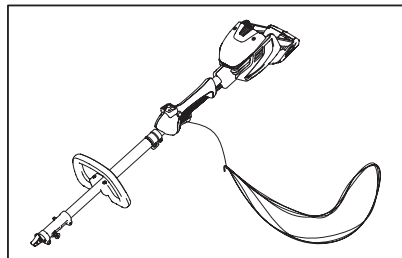

(Fig. 5)

OPERATION



WARNING: Before inserting or removing the battery packs into the line trimmer, make sure the line trimmer is switched off.

Inserting and removing the battery pack

1. Align the groove on the battery pack with the ribs in the line trimmer's battery compartment
2. Insert the battery pack into the line trimmer's battery compartment until it clicks into position.
3. To remove the battery pack, press the battery pack's release button and pull the battery pack out

Adjusting the speed

1. The line trimmer has 3 speed settings.
2. Press the safety button once to turn on the control panel, then press the green button on the control panel to change the speed of the line trimmer.

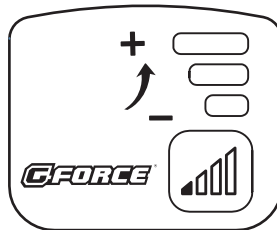

Fig. 6

Turning on and off

1. To turn on the line trimmer, press the safety button, then press and hold the trigger switch.
2. The line trimmer will be turned off when the trigger switch is released.

Bump Feed

The line trimmer is fitted with a bump feed function, which allows the cutting line to be feed out without stopping the line trimmer.

1. While the line trimmer is still on, simply bump the cutting head of the line trimmer on the ground to allow the cutting line to feed out.
2. The bump feed will automatically lock once off the cutting head is off the ground so that the cutting will stop feeding.

CLEANING, MAINTENANCE AND STORAGE



WARNING! Before any cleaning or maintenance, remove the battery from the line trimmer to prevent accidental starting.

Cleaning

1. Use a soft brush to remove the dust and debris from the line trimmer.
2. Keep the line trimmer's cutting heads free of debris.
3. Never use solvents such as petrol, alcohol, ammonia water etc. These solvents may damage the plastic parts.

Maintenance

1. Keep all the nuts, bolts and screws tight.
2. Check the line trimmer for any worn or damaged parts before operating.
3. Replacing the cutting line in the line spool (Fig. 7)
 - i. Remove the line spool from the cutting head.
 - ii. Turn the line spool's top cover so that its arrow/line aligns with the two holes in the line spool.
 - iii. Insert the cutting line into the line spool's hole until it comes out from the other side.
 - iv. Pull the cutting line out from the other side so that the length on both sides are the same.
 - v. Turn the line spool's top cover clockwise to wind the cutting line into the line spool.

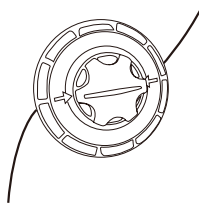

Fig. 7

4. The line trimmer should only be repaired by an authorised service centre.

Storage

1. Remove the battery pack from the line trimmer before storage.
2. Store the line trimmer out of the reach of children in a stable and secure place.

DISPOSAL



Dispose of appliances according to the regulations and requirements of your local council. If appliances are disposed of in landfills or dumps, hazardous substances may leak into the groundwater and get into the food chain, damaging your health and well-being.

TROUBLESHOOTING

Fault	Possible cause	Possible solution
Line trimmer cannot start	The battery pack is not inserted properly	Insert the battery pack again
	The battery pack is low in charge	Charge the battery pack
	The line is jammed	Remove the battery pack and wear protective gloves, then remove the debris from the balde
	Safety button is not pressed	Press the safety button
	The line trimmer is faulty	Repair the line trimmer by an authorised service centre
Line trimmer does not cut properly	There is no more cutting line in the spool	Change the line spool.
Line trimmer is not operating at full capacity	Battery pack is low in charge	Charge the battery pack
	Battery pack has no power	Charge the battery pack
Stop while cutting	Battery pack is not properly inserted into the battery charger	Insert the battery pack onto the battery charger again

WARRANTY

This product is covered by a 2 year parts and labour warranty against manufacturing defects.

Our goods come with guarantees that cannot be excluded under the Australian Consumer Law.

You are entitled to a replacement or refund for a major failure and for compensation for any other reasonably foreseeable loss or damage. You are also entitled to have the goods repaired or replaced if the goods fail to be of acceptable quality and the failure does not amount to a major failure.

- (i) where this product has been subjected to misuse, abuse, accident or want of care;
- (ii) where this product has been used for a purpose for which it was not designed or is not suited;
- (iii) where the service of this product has been undertaken by a non-authorized person or company or if non-approved parts have been used;
- (iv) where this product has been used for trade, industrial or commercial purposes.

In order to obtain warranty service, the purchaser must present the store receipt showing the name of the retailer and the date of purchase.

The period of the warranty begins from the original date of purchase, notwithstanding any subsequent repair or parts replacement.

Purchaser shall be responsible for all transport charges to and from the Authorised Service Centre.

Damage in transit is not covered by this warranty. The purchaser should remove from the product any liquids (if applicable) before sending the product for service or repair.

The product should be packed securely to prevent damage.

WARRANTY EXCLUSIONS

Wear parts or service related parts required when performing normal and regular maintenance of this product are not covered by warranty unless it is found to be defective by an Authorised Service Centre.